

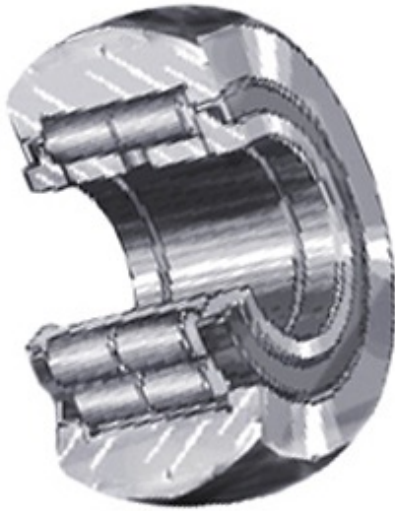

KORTON INDUSTRIAL LIMITED

RBC BEARINGS CRBY 6 Cam Follower and Track Roller - Yoke Type



Bearing No. CRBY 6

CRBY 6 Bearing 2D drawings and 3D CAD models

| | |
|------------------------|--|
| Category | Cam Follower and Track Roller - Yoke Type |
| Inventory | 0.0 |
| Manufacturer Name | RBC BEARINGS |
| Minimum Buy Quantity | N/A |
| Weight | 9.352 |
| EAN | 0637400198954 |
| Product Group | B04120 |
| Roller Surface Profile | Crowned |
| Profile | Yoke Type |
| Enclosure | Sealed |
| Rolling Element | Cylindrical Roller Bearing - Double Row |
| Relubricatable | No |
| Inch - Metric | Inch |
| Other Features | Center Thrust Ring Contact Lip Seal |
| Long Description | 2-1/4" Bore; 6" Roller Diameter; 3-1/4" Roller Width; Crowned Roller; Yoke Type; Sealed; Cylindrical Roller Bearing - Double Row; Not Relubricatable |
| Category | Cam Followers Yoke Type |
| UNSPSC | 31171530 |
| Harmonized Tariff Code | 8482.50.00.00 |
| Noun | Bearing |
| | |



KORTON INDUSTRIAL LIMITED

| Keyword String | Cam Follower |
|--------------------------|---|
| Manufacturer URL | http://www.rbcbearings.com |
| Manufacturer Item Number | CRBY6 |
| Weight / LBS | 20.6 |
| d | 2.25 Inch 57.15 Millimeter |
| Roller Width | 3.25 Inch 82.55 Millimeter |
| Roller Diameter | 6 Inch 152.4 Millimeter |